



Model: **H3**

Universal Cell



## Features

- Capacities: 25kg ~ 30t
- High accuracy
- Alloy steel construction
- Low profile and nice exterior
- With OIML approval: (PTB: D09-03.22)

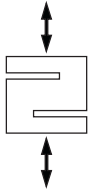

## SPECIFICATIONS

| Capacity                               | t          | 0.025 / 0.05 / 0.1 / 0.25 / 0.5 / 0.75 / 1 / 1.5 / 2 / 2.5 / 3 / 5 / 7.5 / 10 / 15 / 20 / 30 |                  |                        |
|--|------------|--|------------------|------------------------|
| Accuracy Class                         |            | C2   | C3               | C4                     |
| Max. Number of Verification Intervals  | $n_{max}$  | 2000   | 3000             | 4000                   |
| Minimum Loadcell Verification Interval | $V_{min}$  | $E_{max}/5000$   | $E_{max}/10000$  | $E_{max}/14000$        |
| Combined Error                         | %FS        | $\leq \pm 0.030$   | $\leq \pm 0.020$ | $\leq \pm 0.018$       |
| Creep                                  | %FS/30min  | $\leq \pm 0.024$   | $\leq \pm 0.016$ | $\leq \pm 0.012$       |
| Temperature Effect on Sensitivity      | %FS/10°C   | $\leq \pm 0.017$   | $\leq \pm 0.011$ | $\leq \pm 0.009$       |
| Temperature Effect on Zero             | %FS/10°C   | $\leq \pm 0.023$   | $\leq \pm 0.015$ | $\leq \pm 0.010$       |
| Output Sensitivity                     | mv/v       | 2.0 ± 0.004 (Metrical)   |                  | 3.0 ± 0.008 (Imperial) |
| Input Resistance                       | $\Omega$   | 350 ± 3.5  |                  |                        |
| Output Resistance                      | $\Omega$   | 351 ± 2.0  |                  |                        |
| Insulation Resistance                  | M $\Omega$ | $\geq 5000(50VDC)$   |                  |                        |
| Zero Balance                           | %FS        | 1.5 (Metrical)   | 1.5 (Imperial)   |                        |
| Temperature, Compensated               | °C         | -10 ~ +40  |                  |                        |
| Temperature, Allowed                   | °C         | -35 ~ +65  |                  |                        |
| Excitation, Recommended                | v          | 5 ~ 12(DC)   |                  |                        |
| Excitation, Max                        | v          | 18(DC)   |                  |                        |
| Safe Overload                          | %FS        | 120  |                  |                        |
| Ultimate Overload                      | %FS        | 150  |                  |                        |

## Dimension

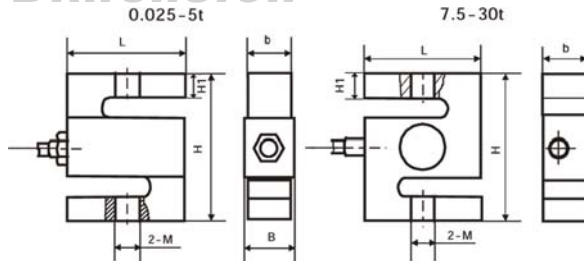

Note: Dimensions in millimeters

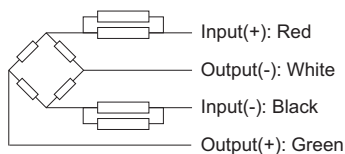

| Capacity    | L    | H     | b    | B    | M         | H1   |
|-------------|------|-------|------|------|-----------|------|
| 25-50 kg    | 50.8 | 76.2  | 12.7 | 14.5 | M8        | 15.7 |
| 0.1 t       | 50.8 | 76.2  | 19.0 | 20.8 | M10 x1.5  | 15.3 |
| 0.25-0.75 t | 50.8 | 76.2  | 19.0 | 20.8 | M12 x1.75 | 13.6 |
| 1 ~ 1.5 t   | 50.8 | 76.2  | 25.4 | 27.2 | M12 x1.75 | 12.1 |
| 2 ~ 5 t     | 76.2 | 101.6 | 25.4 | 27.2 | M20 x1.5  | 20   |
| 7.5 ~ 10 t  | 125  | 175   | 50   | -    | M33 x 3   | 40.2 |
| 15 ~ 20 t   | 160  | 200   | 60   | -    | M42 x 3   | 51   |
| 30 t        | 190  | 230   | 80   | -    | M42 x 3   | 57.5 |

Wiring:  
Standard cable length: 3m(0.025~0.75t)  
6m(1~30t)

گروه مهندسين  
**عمران و صنايع ايران**  
(شرکت سهامی خاص)

WWW.OSIMA.IR  
تلفن: ۸۸۷۱۱۱۶۱ - ۸۸۷۱۱۱۶۷