



Model: **B3G**  
**Universal Cell**



## Features

- Capacities: 50kg ~ 10t
- High accuracy
- Alloy steel construction
- Low profile and nice exterior
- With OIML approval: (PTB: D09-06.07)

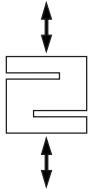

## SPECIFICATIONS

Capacity	t	0.05 / 0.1 / 0.25 / 0.5 / 1 / 2.5 / 5 / 7.5 / 10		
Accuracy Class		C2	C3	C4
Max. Number of Verification Intervals	$n_{max}$	2000	3000	4000
Minimum Loadcell Verification Interval	$V_{min}$	$E_{max}/5000$	$E_{max}/10000$	$E_{max}/14000$
Combined Error	%FS	$\leq \pm 0.030$	$\leq \pm 0.020$	$\leq \pm 0.018$
Creep	%FS/30min	$\leq \pm 0.024$	$\leq \pm 0.016$	$\leq \pm 0.012$
Temperature Effect on Sensitivity	%FS/10°C	$\leq \pm 0.017$	$\leq \pm 0.011$	$\leq \pm 0.009$
Temperature Effect on Zero	%FS/10°C	$\leq \pm 0.023$	$\leq \pm 0.015$	$\leq \pm 0.010$
Output Sensitivity	mv/v	3.0 $\pm$ 0.008		
Input Resistance	$\Omega$	430 $\pm$ 50		
Output Resistance	$\Omega$	351 $\pm$ 2.0		
Insulation Resistance	M $\Omega$	$\geq 5000(50VDC)$		
Zero Balance	%FS	1.0		
Temperature, Compensated	°C	-10 ~ +40		
Temperature, Allowed	°C	-35 ~ +65		
Excitation, Recommended	v	5 ~ 12(DC)		
Excitation, Max	v	18(DC)		
Safe Overload	%FS	120		
Ultimate Overload	%FS	150		

## Dimension

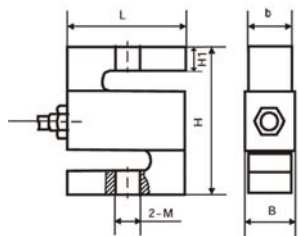

Note: Dimensions in millimeters

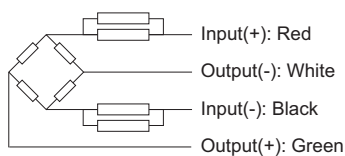

Capacity	L	H	b	B	M	H1
50-100 kg	50.8	63.5	12.7	16.08	M8	10.16
250-500 kg	50.8	63.5	19.05	22.43	M12	10.16
1 t	50.8	63.5	25.4	28.78	M12	10.16
2.5 t	50.8	101.6	25.4	28.78	M20x1.5	15.24
5 t	76.2	101.6	25.4	28.78	M20x1.5	20
7.5 t	101.6	139.7	31.75	35.13	M24x2	31
10 t	127	177.8	50.8	54.18	M30x2	39.9

Wiring:  
 Standard cable length: 3m(0.025-0.75t)  
 6m(1-30t)

گروه مهندسين  
**عمران و صنايع ايران**  
(شرکت سهامی خاص)



WWW.OSIMA.IR  
 تلفن: ۸۸۷۱۱۱۴۱ - ۸۸۷۱۱۱۹۷